

DrugControl®

OBTAINING SPECIMENS SURFACE TESTING / MULTI TEST



Remove the test cassette from the foil pouch just before performing the test. Wipe the area to be tested (e.g. hand [A] or surface [B]) with the absorbent tips of the **DrugControl®** Multi test. Break off tip of buffer vial and fill the cap with buffer [C]. Then push the test cassette into the cap.

DrugControl®

OBTAINING SPECIMENS TESTING LIQUIDS



Open buffer vial (A) and add 2–3 drops of the liquid sample into the vial (B). Close the buffer vial tightly (C). Follow testing procedure as shown on bottom of this page.

DrugControl®

INTERPRETATION OF RESULTS

| | Negative | Positive | Invalid | Invalid |
|------------|----------|----------|---------|---------|
| Multi Test | | | | |
| Test strip | | | | |
| Test card | | | | |

Negative result: two red lines appear in the result window – this indicates that no drug above the cut-off level has been detected. The test line intensity may be any shade of red and may be weaker or stronger than that of the control line.

Positive result: only one red line in the control region (C) and no test line in the test region (T), indicate a positive result.

Invalid result: for a valid result a red line has to appear in the control region (C). Any result obtained without the C-line must not be considered as valid.

Any positive result obtained should be confirmed by an alternative chemical method such as GC/MS.

The elution buffer and solvent (extraction buffer) that are necessary for surface, solid and liquids testing are available at **ulti med Products**.

| | |
|---|------------------|
| Buffer | Order-Nr. |
| Universal Buffer (standard bottle), 2,0ml | 008B020 |
| Universal Buffer (special bottle for all applications), 1,5ml | 008B015 |

DRUGS OF ABUSE DETECTION

Drugs users leave traces of their drug abuse on everything they touch like:

- clothes
- packages
- luggage
- desktops, tables
- in the car
- steering wheel, gear shifter

Although the **DrugControl®** tests were developed for urine specimens, these tests work just as good with any traces of drugs on any surface when using the highly sensitive **DrugControl®** tests in combination with the appropriate extraction buffer.

You will need only a few nanograms of the illicit drugs to be wiped from the suspected surfaces and to follow the instructions overleaf.



SURFACE TESTING / SINGLE TEST

Wipe the area to be tested (e.g. hand [A] or surface [B]) with the absorbent tip of the **DrugControl®** test or a swab. Use buffer to carefully solve absorbed samples from swab [C]. Close the buffer vial tightly [D]. Follow testing procedure as shown on bottom of page 2.



RESINS (e.g. CANNABIS, THC)

Add 3–4 drops of the solvent onto a swab (A). Wipe the resin to be tested 2–3 times with the swab (B). Place the swab into a buffer vial and mix buffer and sample (C). Close the buffer vial tightly (D). Follow testing procedure as shown on bottom of this page.

ATTENTION: The solvent contains concentrated organic solvents. Do not smoke, do not use solvents next to ignition points (open flame etc.), do not bring in contact with materials which can be damaged by solvents.

IMPORTANT: **DrugControl®** tests are highly sensitive. Trace amounts of compounds to be tested are sufficient.

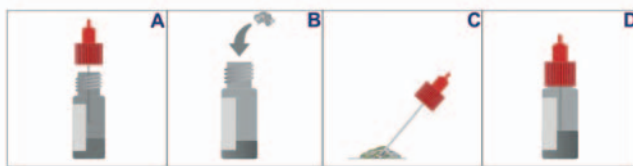

TABLETS / SOLIDS / POWDER

Open buffer vial (A) and place small amount of sample into the vial (B) or dip the spatula (attached to the cap of the vial) into the sample (C). Close the buffer vial tightly (D). Follow testing procedure as shown on bottom of page 2.

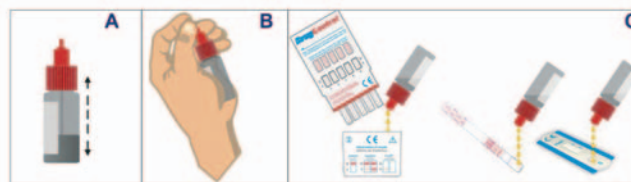

TESTING PROCEDURE

Remove the test cassette from the foil pouch just before performing the test! Mix buffer and sample thoroughly (A). Break off tip of the buffer vial (B).

DrugControl® Multi tests: Fill the cap of the Multi test with the buffer and stick the test cassette into the cap. Wait 10–15 seconds till the absorbing process is finished, remove the test cassette from the cap and place it on a flat surface.

Or give 3–4 drops onto the absorbent tip of a **DrugControl®** teststrip resp.

into the sample well of a **DrugControl®** testkassette (C). The discoloration of the test-(T) and control-(C) lines can be observed within few minutes. The test is completed within 3 to 10 minutes. Do not read results after more than 10 minutes.



PFLANZENTEILE (z.B. THC)

Add 3–4 drops of the solvent into a buffer vial (A). Add 2–3 pieces of the sample (B). Use a swab to carefully mix solvent, buffer and sample (C). Close the buffer vial tightly (D). Follow testing procedure as shown on bottom of page 2.

DETECTABLE COMPOUNDS AND CUT-OFF VALUES

| | | | |
|---|-------|-------------------------------------|--------|
| AMPHETAMINES: | | MORPHINE: | |
| D-Amphetamine | 1000 | Morphine | 300 |
| 3,4-Methylenedioxy-amphetamine | 2000 | Codeine | 300 |
| D,L-Amphetamine | 3000 | 6-Monoacetylmorphine | 400 |
| Phentermine | 3000 | Morphine 3-β-D-glucuronide | 1000 |
| L-Amphetamine | 50000 | Levorphanol | 1500 |
| BARBITURATES: | | Hydromorphone | |
| Butabarbital | 75 | Ethylmorphine | 3000 |
| Butethal | 100 | Norcodeine | 6000 |
| Phenobarbital | 100 | Thebaine | 6000 |
| Alphenal | 150 | Oxycodone | 30000 |
| Aprobarbital | 200 | Hydrocodone | 50000 |
| Amobarbital | 300 | METHADONE: | |
| Secobarbital | 300 | Methadone | 300 |
| Pentobarbital | 300 | Doxylamine | 50000 |
| Cyclopentobarbital | 600 | PHENCYCLIDINE: | |
| Butalbital | 2500 | Phencyclidine | 25 |
| BENZODIAZEPINES: | | 4-Hydroxy-Phencyclidine | |
| Nitrazepam | 100 | TRIC. ANTIDEPRESSANTS: | |
| Clobazam | 100 | Desipramine | 200 |
| Temazepam | 100 | Imipramine | 400 |
| Lorazepam glucuronide | 150 | Nordoxepine | 1000 |
| Alprazolam | 200 | Nortriptyline | 1000 |
| Diazepam | 200 | Amitriptyline | 1500 |
| Clorazepate dipotassium | 200 | Promazine | 1500 |
| Norchlordiazepoxide | 200 | Doxepine | 2000 |
| Oxazepam | 300 | Maprotiline | 2000 |
| Desalkylfurazepam | 300 | Trimipramine | 3000 |
| Flunitrazepam | 400 | Clomipramine | 12500 |
| Nordiazepam | 400 | Promethazine | 25000 |
| Chlordiazepoxide HCl | 750 | MARIJUANA: | |
| Clonazepam | 800 | 11-nor-Δ ⁹ -THC-9 COOH | 30 |
| α-Hydroxy-alprazolam | 1200 | 11-nor-Δ ⁹ -THC-9 COOH | 50 |
| Bromazepam | 1500 | Δ ⁹ -THC | 15000 |
| Chlordiazepoxide | 1500 | Δ ⁸ -THC | 15000 |
| Delorazepam | 1500 | Cannabinol | 20000 |
| Lorazepam | 1500 | ECSTASY: | |
| Estazolam | 2500 | 3,4-Methylenedioxy-ethylamphetamine | 300 |
| Triazolam | 2500 | 3,4-Methylenedioxy-methamphetamine | 500 |
| Midazolam | 12500 | 3,4-Methylenedioxyamphetamine | 3000 |
| COCAINE: | | OPIATES: | |
| Benzoyllecgonine | 300 | Morphine | 2000 |
| Cocaine | 700 | Codeine | 2000 |
| Cocaethylene | 12500 | Morphine 3-β-D-glucuronide | 2000 |
| Ecgonine | 32000 | 6-Monoacetylmorphine | 5000 |
| BUPRENORPHINE: | | Hydromorphone | |
| Buprenorphine | 10 | Ethylmorphine | 5000 |
| Buprenorphine 3-D-glucuronid | 15 | Hydrocodone | 12500 |
| Norbuprenorphine | 20 | Norcodeine | 12500 |
| Norbuprenorphine 3-D-glucuronid | 200 | Procaïn | 15000 |
| METHAMPHETAMINES: | | Oxycodone | |
| D-Methamphetamine | 1000 | Oxymorphone | 25000 |
| 3,4-Methylenedioxy-methamphetamine | 2000 | Normorphine | 50000 |
| L-Methamphetamine | 8000 | Levorphanol | 75000 |
| p-Hydroxy-methamphetamine | 30000 | Thebaine | 100000 |
| Mephentermine | 50000 | PROPOXYPHENE: | |
| MDA: | | D-Propoxyphene | |
| 3,4-Methylene-dioxyamphetamine | 500 | D-Norpropoxyphene | 300 |
| D-Amphetamine | 500 | TRAMADOL: | |
| D,L-Amphetamine | 600 | Tramadol | 200 |
| beta-Phenylethylamine | 9000 | N-desmethyl-tramadol | 500 |
| Tyramine | 10000 | O-desmethyl-tramadol | 20000 |
| EDDP: | | | |
| 2-Ethyliden-1,5-dimethyl-3,3-diphenylpyrrolidine (EDDP) | 100 | | |
| 2-Ethyl-5-methyl-3,3-diphenylpyrrolidine (EMDP) | 200 | | |
| Methadon | 10000 | | |

DrugControl®

ON SITE DRUG OF ABUSE DETECTION

DrugControl® Dipsticks, **DrugControl®** Cassettes and **DrugControl®** Multi Tests are the means of choice for securing evidence. They do not need any additional instruments or reagents. **DrugControl®** is fully equipped to track down trace amounts of drugs of abuse. The testkits are ready for use to check surfaces, solid compounds, tablets, fluids or other suspicious materials.

Using **DrugControl®** securing evidence can be done within minutes.

DrugControl®

Testing of surface, solids and liquids

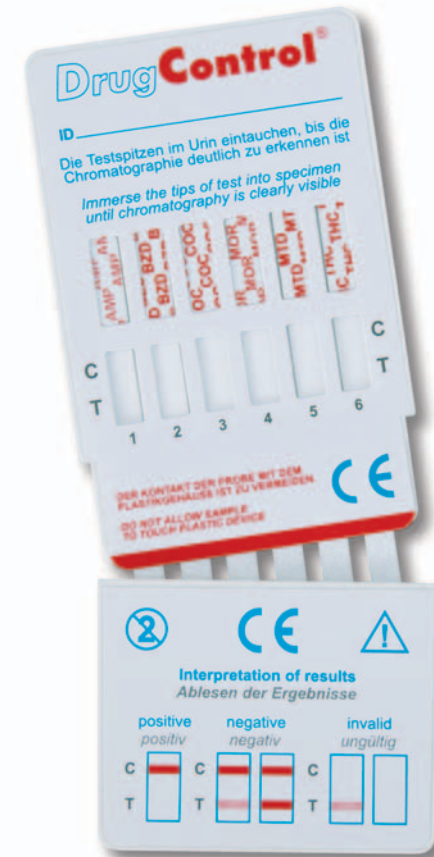

Your first choice...
...a safe decision

Nearly all ulti med Products
are CE marked for professional use

- fulfil the EC regulations 98/79 EC IVD (in-vitro diagnostics)
- cut-off levels according to SAMHSA and NIDA standards
- certified production according to DIN EN ISO 13485:2003
- match with laboratory results GC/MS in >98% of the cases

Manufacturer:

ulti med Products (Deutschland) GmbH

Reeshoop 1 · 22926 Ahrensburg · GERMANY

Tel: +49 (0)4102 - 800 90 · Fax: +49 (0)4102 - 500 82

Email: info@ultimed.org

Distribution:

ulti med Products (Belgium) BVBA

Honzebroekstraat 137 · B-8800 Roeselare · BELGIUM

Tel: +32 (0)51 - 200 425 · Fax: +32 (0)51 - 200 449

Email: belgium@ultimed.org

Stand: 2007/12_Rev_LC

ulti med
www.ultimed.de

ulti med
www.ultimed.de